



SINCE 1950

GOLDEN

Centrifugal Pumps





Message from CEO:

At GOLDEN PUMPS, we believe that we are ideally placed to cater for your pumping needs whether it is a simple mono pump for your residential usage or specialized 'mid-range' projects such as filling stations or sewage, or 'large-scale' applications in the commercial, agricultural, industrial and public sectors.

With more than 6 decades experience in the pump manufacturing industry, GOLDEN PUMPS' engineers are confident that they have both the breadth of knowledge and depth of experience to offer professional services from basic concepts all the way to management of Turn-Key projects & beyond.

We continue to employ highly motivated and capable individuals dedicated to provide solutions that maximize value for our customers. Our people strive to help customers to address their specified needs in a cost effective manner.

The quality of our products, we believe, is the key for the continuous increase in our clientele and thus contributed to the phenomenal growth of our company.

Today's customer demands products that are the latest in technology along with the highest degree of reliability and their durability. That's what you get with GOLDEN PUMPS' cutting-edge product design utilizing the modern technology, rock solid performance and a lifetime convenience.

And when we say "For Life", we mean it.

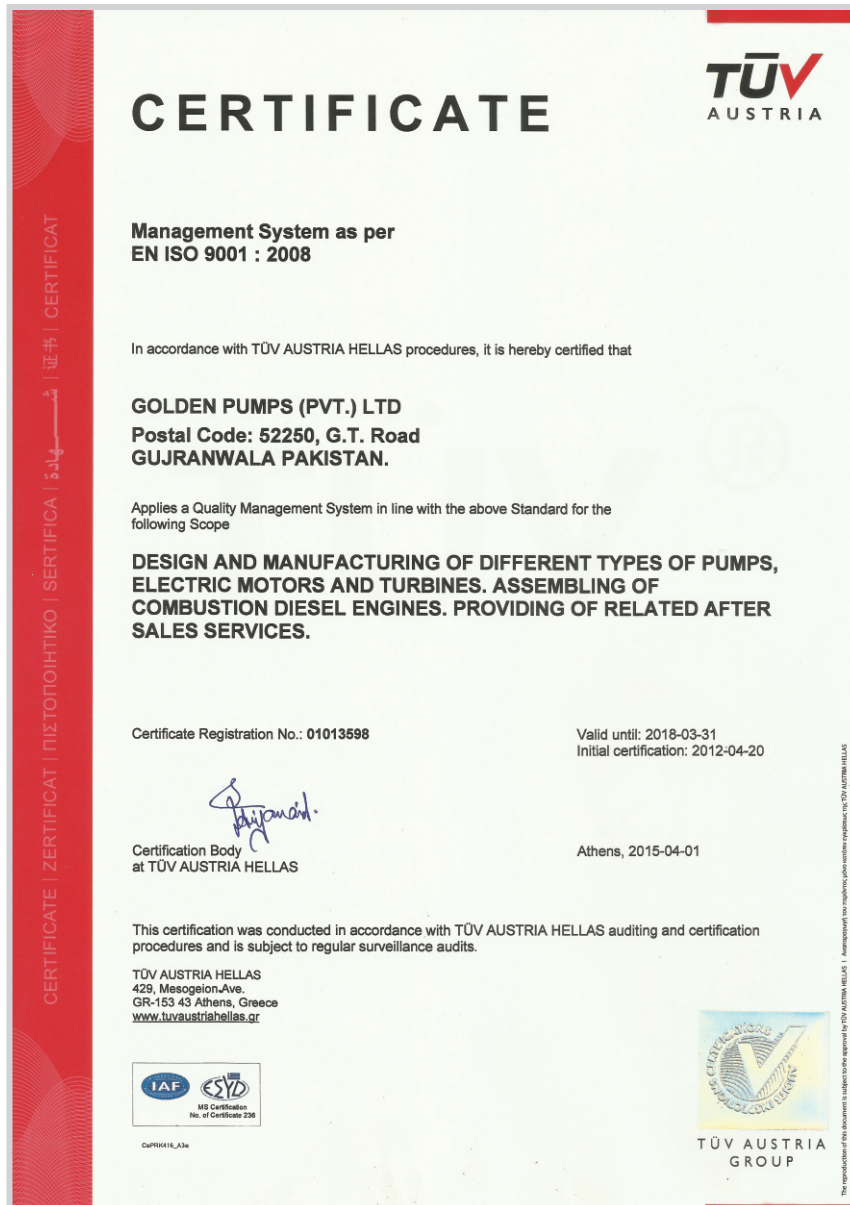

ISO Certification

Company has been awarded the ISO-9000:2000 'QUALITY MANAGEMENT CERTIFICATE'. Besides, it's the leading Pakistani company among pumps, electric motors and diesel engines manufacturing companies to achieve "ISO-9001:2000 accreditation for designing, development, procurement, manufacturing, inspection, testing and delivery with after-sales service for all types of Pumps, Electric Motors, Deep-Well Turbines and Diesel Engines."

Company would like to thank its valued customers, dealers and suppliers for their continuous support and feedback in all spheres of activities. Company is further improving efficiency to achieve excellence in its cordial customer relationship and ensure moral integrity in its dealings.



SINCE 1950

GOLDEN Centrifugal Pumps

GCP is a series of Centrifugal Pumps with Radial Type Vanes, Closed Impeller for different delivery heads and pumping capacity. These are Horizontal Single-Stage or Double-Stage End Suction Centrifugal Pumps with solid construction offering continuous reliability, trouble-free service and high performance. These pumps are available with Loose Fast Flat Belt Pulley, V-Belt Pulley and in Bare Shaft models. Bare Shaft Pumps can be fitted with a heavy duty pedestal to give the machine high rigidity necessary for coupling it with Electric Motor. In case where it is not feasible to use Electric Motor, 'GOLDEN Diesel Engine' (Combustion Engine) can also be used as prime mover.

These pumps feature an oversized support with Grease-Lubricated (ZZ) Japanese Ball Bearings for longer life. According to specifications in some Bearing Housings Oil is used while in others Grease is used. Pumps with Mechanical Seals are also available with Stainless Steel Shaft. Similarly, pumps with Soft-Packed Gland Seal are equipped with Stainless Steel or Carbon Steel Shaft according to the customer's demand.

Closed Impellers are used (according to the customer's requirement) of Close Grained Cast Iron, S. G. Iron, Bronze or Stainless Steel, dynamically balanced for smooth running. Similarly, Body and Suction Cover are used (according to the customer's requirement) of Close Grained Cast Iron or Stainless Steel. All other components of the pumps are made of the best suited materials and machined under strict 'Quality Control' supervision to ensure a perfect and longer operating life.

These pumps comprise vast experience acquired both in designing and manufacturing, as well as, in the most common applications, such as, Public or Industrial Water Supply, Construction Sites, Hotels, Fire Fighting Stations, Irrigation, Fresh Water Handling, Hot or Over-Heated Water Circulation in Heating Systems, etc.

The extended model range, the possibility of direct coupling to Electric Motor or 'GOLDEN Diesel Engine' (Combustion Engine) and availability of special construction of 'Mobile Trolley' on demand are enabling offers for each of the different applications, the best solution for dependability, efficiency and energy conservation.

These pumps are not only suitable for clean, chemically and mechanically non-aggressive waters but also designed for a wide range of industrial chemicals.

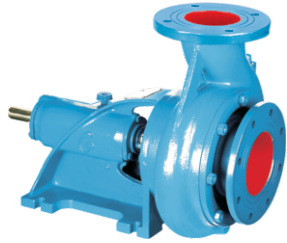

Bare Shaft Pump



Mono-Block Pump

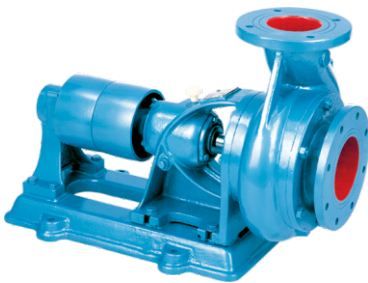

Loose-Fast Pulley Pump



V-Belt Pulley Pump



Bare-Shaft Pump
coupled with Diesel Engine

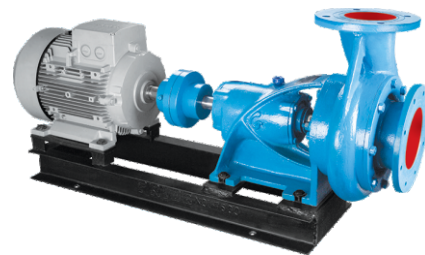

Bare-Shaft Pump
coupled with Electric Motor



Bare-Shaft Pump
coupled with Diesel Engine on Trolley



V-Belt Pulley Pump
coupled with Diesel Engine on Trolley



SINCE 1950

GOLDEN Centrifugal Pump

(Cross - Sectional View)

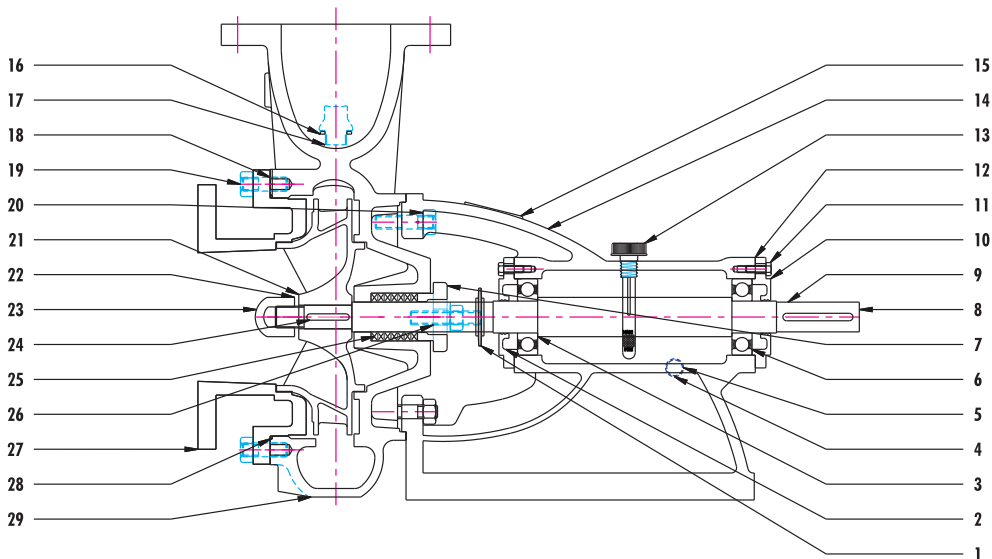
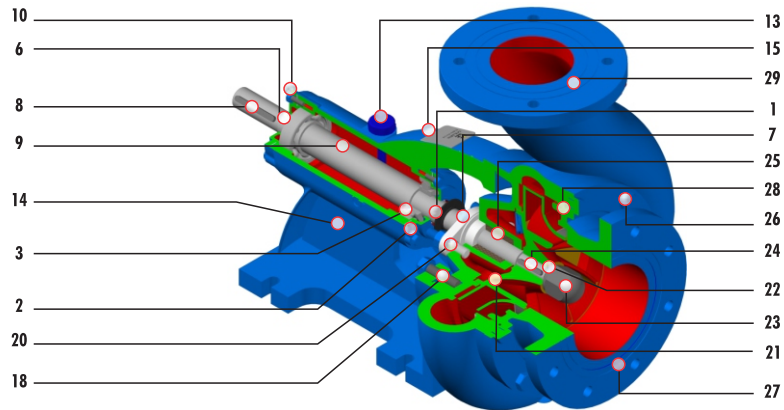

No.	Description	Material
1	Splash Shield	Rubber
2	Bearing Plate (int. side)	Cast Iron
3	Ball Bearing (Pump Side)	Shielded Type - zz
4	O - Ring (Oil Drain Plug)	Mild Steel
5	Oil Drain Plug	Mild Steel
6	Ball Bearing (Drive Side)	Shielded Type - zz
7	Gland Plate	Cast Iron / Bronze
8	Key Coupling / Pulley	Mild Steel
9	Shaft	Carbon Steel / S. Steel
10	Bearing Plate (ext. side)	Cast Iron
11	Bolt	Mild Steel
12	Gasket	Paper
13	Oil Guage	Plastic
14	Bearing Housing	Cast Iron
15	Name Plate	Mild Steel

No.	Description	Material
16	O - Ring (Prime Plug)	Rubber
17	Prime Plug	Mild Steel
18	Stud 2 (Bearing Housing)	Mild Steel
19	Nut	Mild Steel
20	Stud 3 (Gland Plate)	Mild Steel
21	Impeller	Cast Iron / Bronze / S. Steel
22	Spring Washer	Mild Steel
23	Impeller Nut	Cast Iron / S. Steel
24	Key 1 (Impeller)	Mild Steel
25	Stuffing Box	Gland Packing / Mech. Seal
26	Stud 1 (Suction Cover)	Mild Steel
27	Suction Cover	Cast Iron / S. Steel
28	O - Ring (Suction Cover)	Rubber
29	Volute Casing	Cast Iron / S. Steel

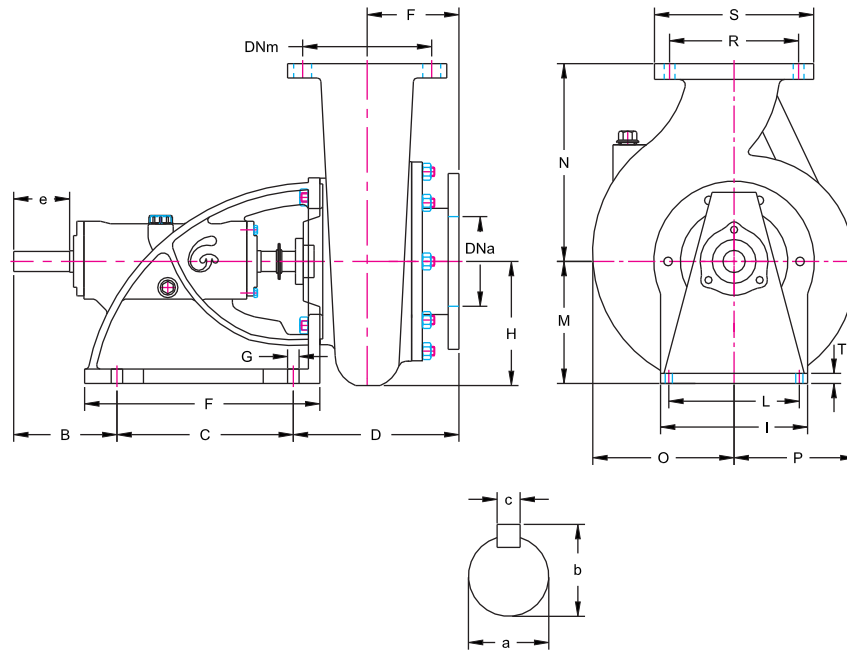

Dimension Table of GOLDEN Centrifugal Pumps (Bare Shaft)

Items #	Model	Size	Bearing	DNa	DNm	A	B	C	D	E	F	G	H	I	L	M	N	O	P	T	Shaft Projection	Weight /kg
						mm																
1	GCP 40-21	2" x 1.5"	6206	50	40	550	130	190	230	114	280	18	140	175	125	160	195	140	140	20	1	52
2	GCP 50-17	2.5" x 2"	6206	65	50	605	130	190	285	112	280	18	128	175	125	160	176	130	120	20	1	46
3	GCP 50-24	2.5" x 2"	6306	65	50	600	140	244	216	114	330	16	160	205	165	170	242	160	157	20	2	67
4	GCP 65-22	3" x 2.5"	6206	75	65	580	130	190	260	112	280	18	150	175	125	160	230	160	142	20	1	57
5	GCP 65-27	3" x 2.5"	6306	80	65	610	140	244	226	122	330	16	204	205	165	170	300	210	185	20	2	84
6	GCP 80-22	4" x 3"	6306	100	80	606	140	244	222	120	330	16	162	205	165	170	250	168	155	20	2	68
7	GCP 80-27	4" x 3"	6306	100	80	610	140	244	226	130	330	16	205	205	165	170	300	210	185	20	2	84
8	GCP 80-31	4" x 3"	6408	100	80	664	175	238	251	175	335	20	218	205	165	196	316	224	201	20	3	108
9	GCP 100-22	5" x 4"	6306	125	100	610	140	244	226	118	330	16	170	205	165	170	279	194	163	20	2	72
10	GCP 100-27	5" x 4"	6408	125	100	680	175	238	267	145	335	20	208	205	165	196	300	215	178	20	3	105
11	GCP 100-33	5" x 4"	6408	125	100	683	175	238	270	140	335	20	230	205	165	196	382	240	218	20	3	132
12	GCP 125-24	6" x 5"	6408	150	125	690	175	238	278	150	335	20	200	205	165	196	306	215	170	20	3	103
13	GCP 125-27	6" x 5"	6408	150	125	695	175	238	282	152	335	20	222	205	165	196	342	240	204	20	3	121
14	GCP 150-27-6	6" x 6"	6408	150	150	700	175	238	287	150	335	20	215	205	165	196	256	237	193	20	3	119
15	GCP 150-27	7" x 6"	6408	175	150	713	175	238	300	174	335	20	215	205	165	196	256	237	193	20	3	125

Shaft Projection

Type	a	b	c	e
	mm			
1	28	32	8	76
2	28	32	8	84
3	38	42	8	125

Flanges

Port ϕ	R	S	Holes	
	ϕ mm		No.	ϕ mm
40	100	130	4	16
50	110	140	4	16
65	130	160	4	16
80	150	190	4	16
100	180	220	4	18
125	210	250	8	18
150	225	265	8	20



SINCE 1950

GOLDEN Centrifugal Pumps

GCP 40-21-205 (2" x 1.5") / 2 HP / 1450 rpm
 GCP 50-17-170 (2.5" x 2") / 2 HP / 1450 rpm

GCP 50-24-215 (2.5" x 2") / 3 HP / 1450 rpm
 GCP 50-24-240 (2.5" x 2") / 5 HP / 1450 rpm

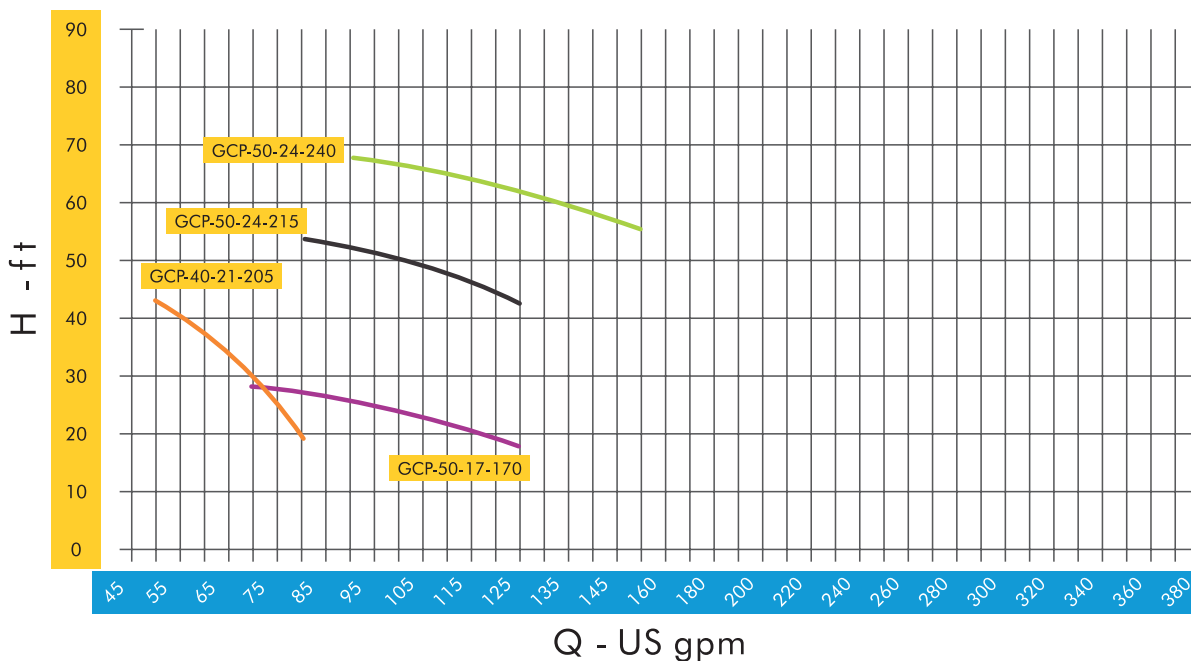

GCP 65-22-155 (3" x 2.5") / 3 HP / 1450 rpm
 GCP 65-22-217 (3" x 2.5") / 5 HP / 1450 rpm

GCP 65-27-255 (3" x 2.5") / 7.5 HP / 1450 rpm
 GCP 65-27-270 (3" x 2.5") / 10 HP / 1450 rpm

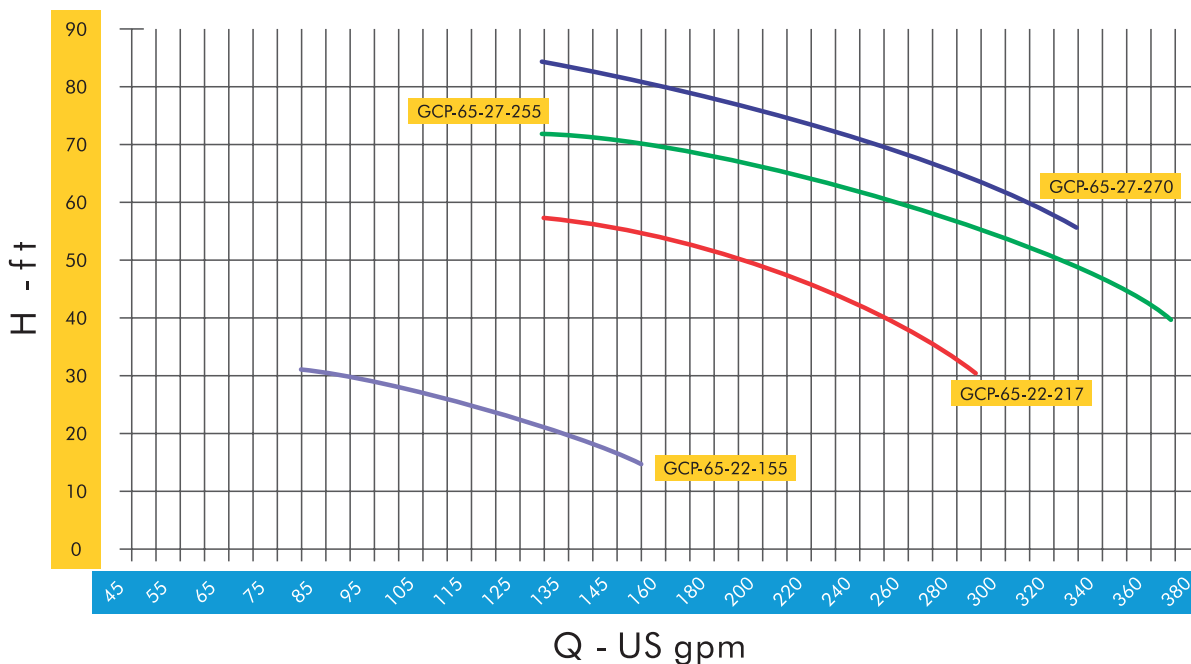



SINCE 1950

GOLDEN Centrifugal Pumps

GCP 80-22-170 (4" x 3") / 3 HP / 1450 rpm
 GCP 80-22-200 (4" x 3") / 5 HP / 1450 rpm
 GCP 80-22-222 (4" x 3") / 7.5 HP / 1450 rpm
 GCP 80-27-245 (4" x 3") / 7.5 HP / 1450 rpm

GCP 80-27-265 (4" x 3") / 10 HP / 1450 rpm
 GCP 80-31-270 (4" x 3") / 10 HP / 1450 rpm
 GCP 80-31-310 (4" x 3") / 15 HP / 1450 rpm

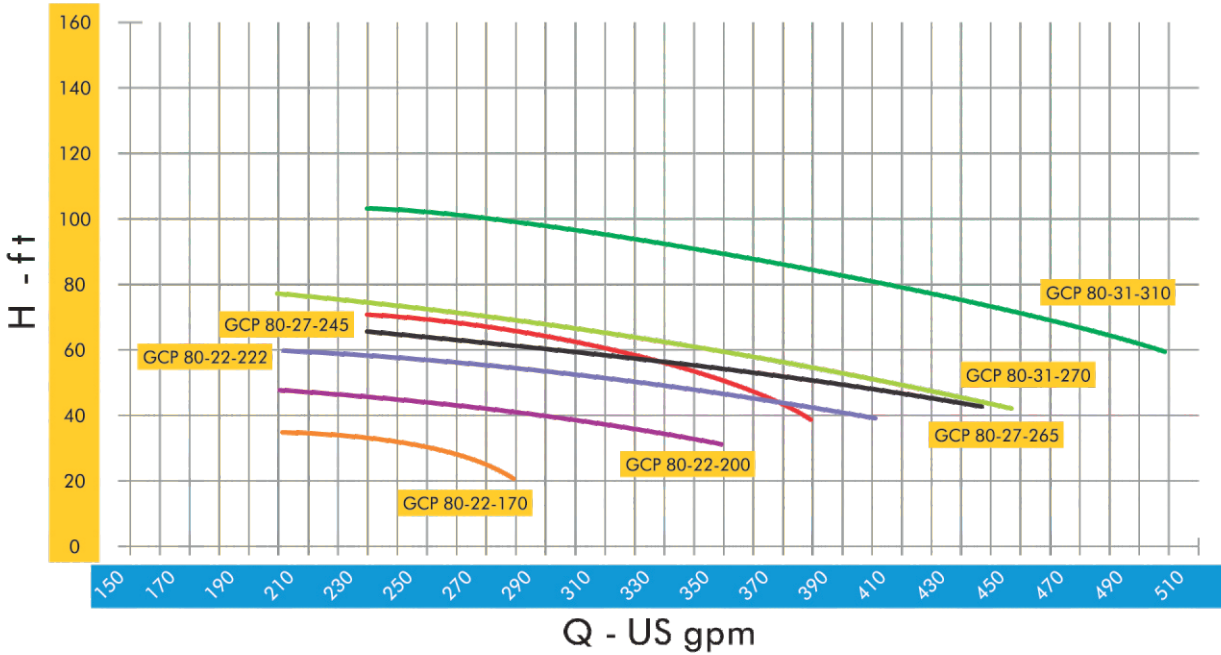

GCP 100-22-180 (5" x 4") / 5 HP / 1450 rpm
 GCP 100-22-195 (5" x 4") / 7.5 HP / 1450 rpm
 GCP 100-22-212 (5" x 4") / 10 HP / 1450 rpm
 GCP 100-27-230 (5" x 4") / 10 HP / 1450 rpm

GCP 100-27-265 (5" x 4") / 15 HP / 1450 rpm
 GCP 100-33-305 (5" x 4") / 20 HP / 1450 rpm
 GCP 100-33-333 (5" x 4") / 55 HP / 1450 rpm

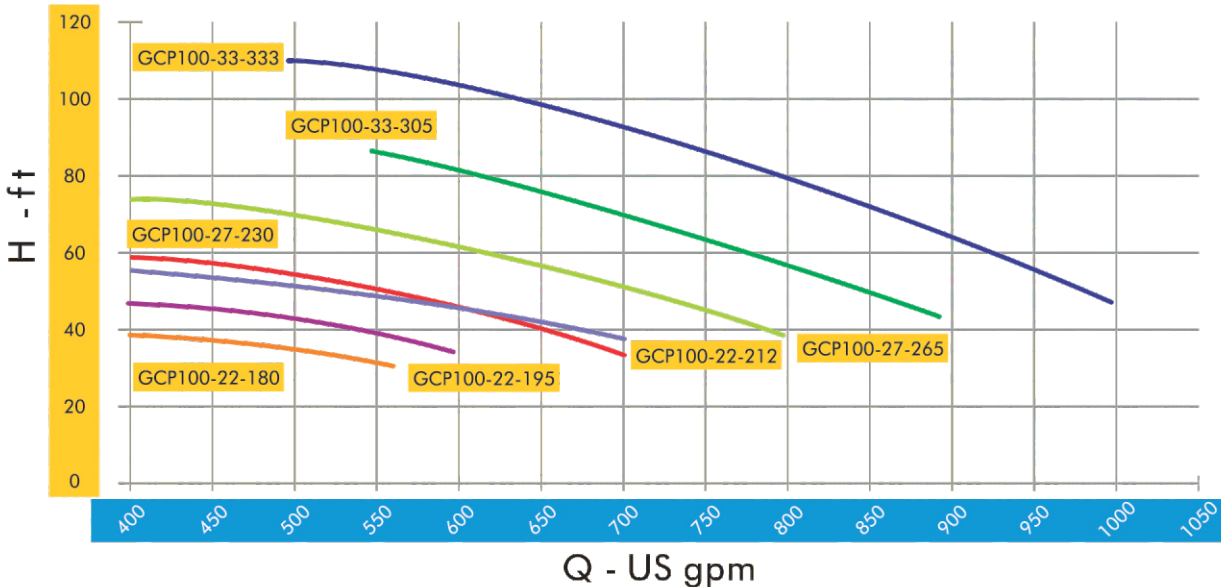



SINCE 1950

GOLDEN Centrifugal Pumps

GCP 125-24-205 (6" x 5") / 10 HP / 1450 rpm

GCP 125-24-230 (6" x 5") / 15 HP / 1450 rpm

GCP 125-24-242 (6" x 5") / 20 HP / 1450 rpm

GCP 125-27-250 (6" x 5") / 20 HP / 1450 rpm

GCP 125-27-265 (6" x 5") / 25 HP / 1450 rpm

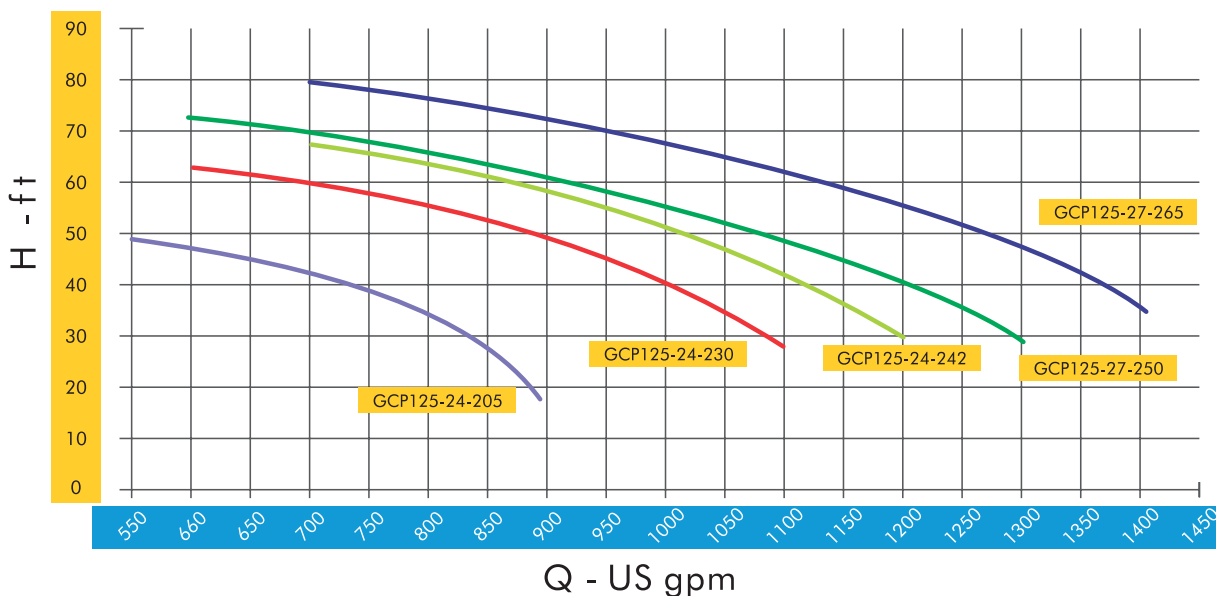

GCP 150-27-6-225 (6" x 6") / 20 HP / 1450 rpm

GCP 150-27-6-245 (6" x 6") / 25 HP / 1450 rpm

GCP 150-27-6-260 (6" x 6") / 30 HP / 1450 rpm

GCP 150-27-245 (7" x 6") / 20 HP / 1450 rpm

GCP 150-27-265 (7" x 6") / 25 HP / 1450 rpm

GCP 150-27-270 (7" x 6") / 30 HP / 1450 rpm

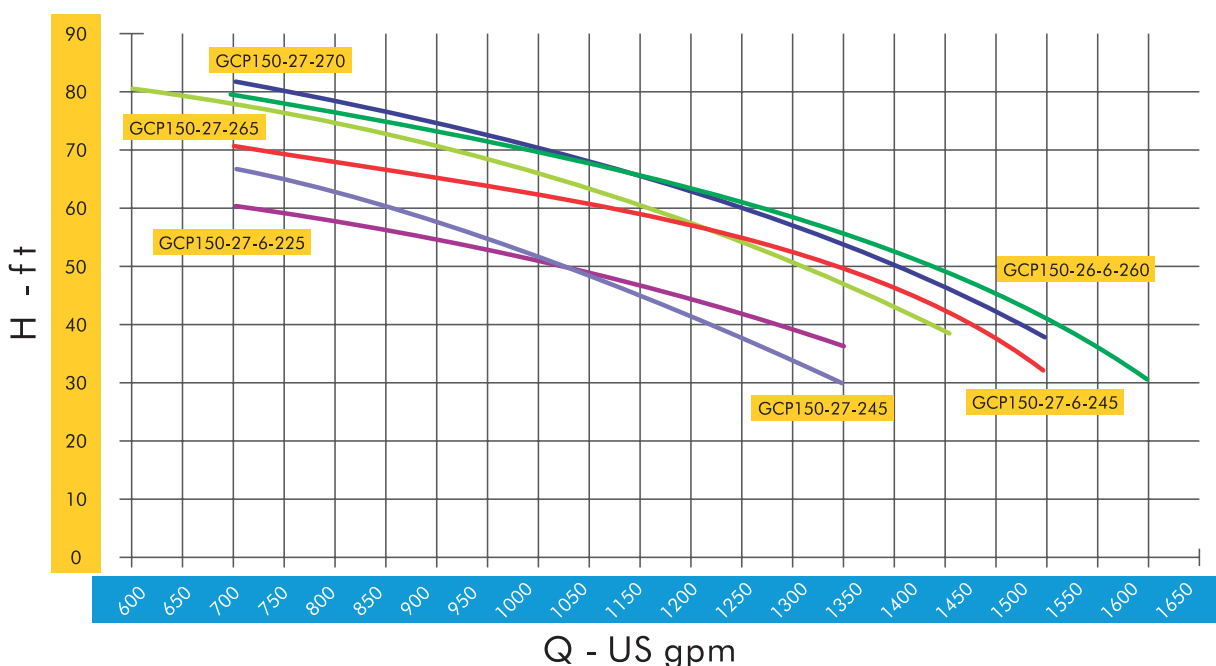

GOLDEN PUMPS (PVT) LTD.

Climax Town, Pindi Bypass,
G. T. Road, Gujranwala, PAKISTAN
Tel: +92 55 3857621, 3857622
E-mail: sales@goldenpumps.com.pk
Web: www.goldenpumps.com.pk



Approved in :



Member of :



Pakistan Pumping &
ppemma
Electric Motors Manufacturers Association